



Admission Information

Use this form to collect all required information about a child enrolling in day care.

Directions: The day care provider gives this form to the child's parent or guardian. The parent or guardian completes the form in its entirety and returns it to the day care provider before the child's first day of enrollment. The day care provider keeps the form on file at the child care facility.

General Information

Operation's Name		Director's Name	
Child's Full Name	Child's Date of Birth	Child Lives With <input type="radio"/> Both parents <input type="radio"/> Mom <input type="radio"/> Dad <input type="radio"/> Guardian	
Child's Home Address		Date of Admission	Date of Withdrawal
Name of Parent or Guardian Completing Form	Address of Parent or Guardian (if different from the child's)		
List telephone numbers below where parents/guardian may be reached while child is in care.			
Parent 1 Telephone No.	Parent 2 Telephone No.	Guardian's Telephone No.	Custody Documents on File <input type="radio"/> Yes <input type="radio"/> No
Give the name, address, and phone number of the responsible individual to call in case of an emergency if parents/guardian cannot be reached			Relationship

I authorize the child care operation **to release** my child to leave the child care operation **ONLY** with the following persons. Please list name and telephone number for each. Children will only be released to a parent or guardian or to a person designated by the parent/guardian after verification of ID.

Name	Phone Number
Name	Phone Number
Name	Phone Number

Consent Information

Check All That Apply:

1. Transportation
I give consent for my child to be transported and supervised by the operation's employees:
 for emergency care on field trips to and from home to and from school

2. Field Trips
 I give consent for my child to participate in field trips.
 I do not give consent for my child to participate in field trips.
 Comments

3. Water Activities

I give consent for my child to participate in the following water activities:

- water table play
 sprinkler play
 splashing/wading pools
 swimming pools
 aquatic playgrounds

4. Receipt of Written Operational Policies (Check All that Apply)

I acknowledge receipt of the facility's operational policies, including those for:

- | | |
|--|---|
| <input type="checkbox"/> Discipline and guidance | <input type="checkbox"/> Procedures for release of children |
| <input type="checkbox"/> Suspension and expulsion | <input type="checkbox"/> Illness and exclusion criteria |
| <input type="checkbox"/> Emergency plans | <input type="checkbox"/> Procedures for dispensing medications |
| <input type="checkbox"/> Procedures for conducting health checks | <input type="checkbox"/> Immunization requirements for children |
| <input type="checkbox"/> Safe sleep | <input type="checkbox"/> Meals and food service practices |
| <input type="checkbox"/> Procedures for parents to discuss concerns with the director | <input type="checkbox"/> Procedures to visit the center without securing prior approval |
| <input type="checkbox"/> Procedures for parents to participate in operation activities | <input type="checkbox"/> Procedures for parents to contact Child Care Licensing (CCL), DFPS, Child Abuse Hotline, and CCL website |

5. Meals

I understand that the following meals will be served to my child while in care:

- None
 Breakfast
 Morning snack
 Lunch
 Afternoon snack
 Supper
 Evening snack

6. Days and Times in Care

My child is normally in care on the following days and times:

Day of the Week	A.M.	P.M.
Monday		
Tuesday		
Wednesday		
Thursday		
Friday		
Saturday		
Sunday		

Authorization For Emergency Medical Attention

In the event I cannot be reached to make arrangements for emergency medical care, I authorize the person in charge to take my child to:

Name of Physician	Address	Phone Number
Name of Emergency Care Facility	Address	Phone Number

I give consent for the facility to secure any and all necessary emergency medical care for my child.

 Signature — Parent or Legal Guardian

Child's Additional Information Section

List any special needs that your child may have, such as environmental allergies, food intolerances, existing illness, previous serious illness, injuries and hospitalizations during the past 12 months, any medication prescribed for long-term continuous use, and any other information which caregivers should be aware of:

Does your child have diagnosed food allergies? Yes No Plan Submitted on _____

Child day care operations are public accommodations under the Americans with Disabilities Act (ADA), Title III. If you believe that such an operation may be practicing discrimination in violation of Title III, you may call the ADA Information Line at (800) 514-0301 (voice) or (800) 514-0383 (TTY).

Signature — Parent or Legal Guardian

Date Signed

School Age Children

My child attends the following school

School Phone Number

My child has permission to (check all that apply):

walk to or from school or home ride a bus be released to the care of his/her sibling under 18 years old

Authorized pick up/drop off locations other than the child's address

Child's required immunizations, vision and hearing screening, and TB screening are current and on file at their school.

Admission Requirement

If your child does not attend pre-kindergarten or school away from the child care operation, one of the following must be presented when your child is admitted to the child care operation or within one week of admission.

Check **only one** option:

1. Health Care Professional's Statement: I have examined the above named child within the past year and find that he or she is able to take part in the day care program.

Signature — Health Care Professional

Date Signed

2. A signed and dated copy of a health care professional's statement is attached.

3. Medical diagnosis and treatment conflict with the tenets and practices of a recognized religious organization, which I adhere to or am a member of. I have attached a signed and dated affidavit stating this.

4. My child has been examined within the past year by a health care professional and is able to participate in the day care program. Within 12 months of admission, I will obtain a health care professional's signed statement and submit it to the child care operation.

Name

Address of Health Care Professional

Signature — Parent or Legal Guardian

Date Signed

Requirements for Exclusion

- I have attached a signed and dated affidavit stating that I decline immunizations for reason of conscience, including religious belief, on the form described by Section 161.0041 Health and Safety Code submitted no later than the 90th day after the affidavit is notarized.
- I have attached a signed and dated affidavit stating that the vision or hearing screening conflicts with the tenets or practices of a church or religious denomination that I am an adherent or member of.

Vision Exam Results

Right Eye 20/ Left Eye 20/ Pass Fail

Signature

Date Signed

Hearing Exam Results

Ear	1000 Hz	2000 Hz	4000 Hz	Pass or Fail
Right				<input type="radio"/> Pass <input type="radio"/> Fail
Left				<input type="radio"/> Pass <input type="radio"/> Fail

Signature

Date Signed

Vaccine Information

The following vaccines require multiple doses over time. Please provide the date your child received each dose.

Vaccine	Vaccine Schedule	Dates Child Received Vaccine
Hepatitis B	Birth (first dose)	
	1–2 months (second dose)	
	6–18 months (third dose)	
Rotavirus	2 months (first dose)	
	4 months (second dose)	
	6 months (third dose)	
Diphtheria, Tetanus, Pertussis	2 months (first dose)	
	4 months (second dose)	
	6 months (third dose)	
	15–18 months (fourth dose)	
	4–6 years (fifth dose)	
Haemophilus Influenza Type B	2 months (first dose)	
	4 months (second dose)	
	6 months (third dose)	
	12–15 months (fourth dose)	
Pneumococcal	2 months (first dose)	
	4 months (second dose)	
	6 months (third dose)	

Vaccine	Vaccine Schedule	Dates Child Received Vaccine
	12–15 months (fourth dose)	
Inactivated Poliovirus	2 months (first dose)	
	4 months (second dose)	
	6–18 months (third dose)	
	4–6 years (fourth dose)	
Influenza	Yearly, starting at 6 months. Two doses given at least four weeks apart are recommended for children who are getting the vaccine for the first time and for some other children in this age group.	
Measles, Mumps, Rubella	12–15 months (first dose)	
	4–6 years (second dose)	
Varicella	12–15 months (first dose)	
	4–6 years (second dose)	
Hepatitis A	12–23 months (first dose)	
	The second dose should be given 6 to 18 months after the first dose.	

Physician or Public Health Personnel Verification

Signature or stamp of a physician or public health personnel verifying immunization information above:

_____ Signature

_____ Date Signed

Varicella (Chickenpox)

Varicella (chickenpox) vaccine is not required if your child has had chickenpox disease. If your child has had chickenpox, please complete the statement: My child had varicella disease (chickenpox) on or about (date) _____ and does not need varicella vaccine.

_____ Signature

_____ Date Signed

Additional Information Regarding Immunizations

For additional information regarding immunizations, visit the Texas Department of State Health Services website at www.dshs.state.tx.us/immunize/public.shtm.

TB Test (If Required)

Positive Negative Date: _____

Gang Free Zone

Under the Texas Penal Code, any area within 1,000 feet of a child care center is a gang-free zone, where criminal offenses related to organized criminal activity are subject to harsher penalties.

Privacy Statement

HHSC values your privacy. For more information, read our privacy policy online at: <https://hhs.texas.gov/policies-practices-privacy#security>

Signatures

Child's Parent or Legal Guardian

Date Signed

Center Designee

Date Signed



Name: _____ D.O.B.: _____

Allergy to: _____

Weight: _____ lbs. Asthma: **Yes (higher risk for a severe reaction)** **No**

NOTE: Do not depend on antihistamines or inhalers (bronchodilators) to treat a severe reaction. USE EPINEPHRINE.

Extremely reactive to the following allergens: _____

THEREFORE:

- If checked, give epinephrine immediately if the allergen was **LIKELY** eaten, for **ANY** symptoms.
- If checked, give epinephrine immediately if the allergen was **DEFINITELY** eaten, even if no symptoms are apparent.

FOR ANY OF THE FOLLOWING:
SEVERE SYMPTOMS



LUNG

Shortness of breath, wheezing, repetitive cough



HEART

Pale or bluish skin, faintness, weak pulse, dizziness



THROAT

Tight or hoarse throat, trouble breathing or swallowing



MOUTH

Significant swelling of the tongue or lips



SKIN

Many hives over body, widespread redness



GUT

Repetitive vomiting, severe diarrhea



OTHER

Feeling something bad is about to happen, anxiety, confusion

OR A COMBINATION of symptoms from different body areas.



1. **INJECT EPINEPHRINE IMMEDIATELY.**
2. **Call 911.** Tell emergency dispatcher the person is having anaphylaxis and may need epinephrine when emergency responders arrive.
 - Consider giving additional medications following epinephrine:
 - » Antihistamine
 - » Inhaler (bronchodilator) if wheezing
 - Lay the person flat, raise legs and keep warm. If breathing is difficult or they are vomiting, let them sit up or lie on their side.
 - If symptoms do not improve, or symptoms return, more doses of epinephrine can be given about 5 minutes or more after the last dose.
 - Alert emergency contacts.
 - Transport patient to ER, even if symptoms resolve. Patient should remain in ER for at least 4 hours because symptoms may return.

MILD SYMPTOMS



NOSE

Itchy or runny nose, sneezing



MOUTH

Itchy mouth



SKIN

A few hives, mild itch



GUT

Mild nausea or discomfort

FOR MILD SYMPTOMS FROM MORE THAN ONE SYSTEM AREA, GIVE EPINEPHRINE.

FOR MILD SYMPTOMS FROM A SINGLE SYSTEM AREA, FOLLOW THE DIRECTIONS BELOW:

1. Antihistamines may be given, if ordered by a healthcare provider.
2. Stay with the person; alert emergency contacts.
3. Watch closely for changes. If symptoms worsen, give epinephrine.

MEDICATIONS/DOSES

Epinephrine Brand or Generic: _____

Epinephrine Dose: 0.1 mg IM 0.15 mg IM 0.3 mg IM

Antihistamine Brand or Generic: _____

Antihistamine Dose: _____

Other (e.g., inhaler-bronchodilator if wheezing): _____



FARE

Food Allergy Research & Education

FOOD ALLERGY & ANAPHYLAXIS EMERGENCY CARE PLAN

HOW TO USE AUVI-Q® (EPINEPRHINE INJECTION, USP), KALEO

1. Remove Auvi-Q from the outer case.
2. Pull off red safety guard.
3. Place black end of Auvi-Q against the middle of the outer thigh.
4. Press firmly until you hear a click and hiss sound, and hold in place for 2 seconds.
5. Call 911 and get emergency medical help right away.

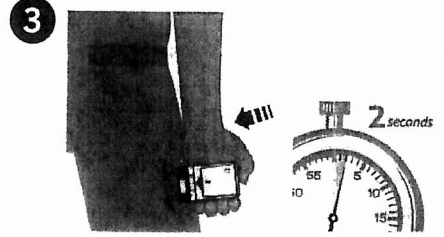

HOW TO USE EPIPEN® AND EPIPEN JR® (EPINEPHRINE) AUTO-INJECTOR AND EPINEPHRINE INJECTION (AUTHORIZED GENERIC OF EPIPEN®), USP AUTO-INJECTOR, MYLAN AUTO-INJECTOR, MYLAN

1. Remove the EpiPen® or EpiPen Jr® Auto-Injector from the clear carrier tube.
2. Grasp the auto-injector in your fist with the orange tip (needle end) pointing downward.
3. With your other hand, remove the blue safety release by pulling straight up.
4. Swing and push the auto-injector firmly into the middle of the outer thigh until it 'clicks'.
5. Hold firmly in place for 3 seconds (count slowly 1, 2, 3).
6. Remove and massage the injection area for 10 seconds.
7. Call 911 and get emergency medical help right away.

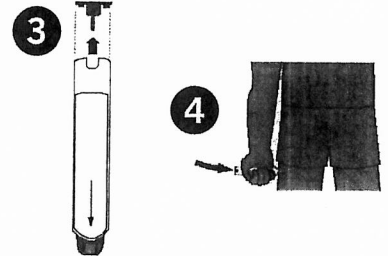

HOW TO USE IMPAX EPINEPHRINE INJECTION (AUTHORIZED GENERIC OF ADRENACLICK®), USP AUTO-INJECTOR, IMPAX LABORATORIES

1. Remove epinephrine auto-injector from its protective carrying case.
2. Pull off both blue end caps: you will now see a red tip.
3. Grasp the auto-injector in your fist with the red tip pointing downward.
4. Put the red tip against the middle of the outer thigh at a 90-degree angle, perpendicular to the thigh.
5. Press down hard and hold firmly against the thigh for approximately 10 seconds.
6. Remove and massage the area for 10 seconds.
7. Call 911 and get emergency medical help right away.

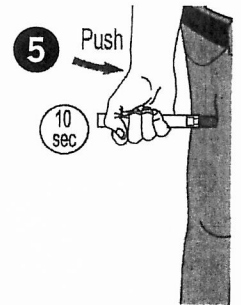

ADMINISTRATION AND SAFETY INFORMATION FOR ALL AUTO-INJECTORS:

1. Do not put your thumb, fingers or hand over the tip of the auto-injector or inject into any body part other than mid-outer thigh. In case of accidental injection, go immediately to the nearest emergency room.
2. If administering to a young child, hold their leg firmly in place before and during injection to prevent injuries.
3. Epinephrine can be injected through clothing if needed.
4. Call 911 immediately after injection.

OTHER DIRECTIONS/INFORMATION (may self-carry epinephrine, may self-administer epinephrine, etc.):

Treat the person before calling emergency contacts. The first signs of a reaction can be mild, but symptoms can worsen quickly.

EMERGENCY CONTACTS — CALL 911

RESCUE SQUAD: _____

DOCTOR: _____ PHONE: _____

PARENT/GUARDIAN: _____ PHONE: _____

OTHER EMERGENCY CONTACTS

NAME/RELATIONSHIP: _____

PHONE: _____

NAME/RELATIONSHIP: _____

PHONE: _____

Purpose:

These questions are designed to give you the information needed to provide the best, most appropriate care for children. This information is confidential and parents must be reassured it will not be shared without their written permission.

Experts in the field recommend completing an assessment form for each child. It can help start mutual trust and respect that will develop into a strong, cooperative partnership between parents and caregivers.

The assessment should be completed prior to enrollment. Give parents an opportunity to review your enrollment forms and parent handbook before you complete the assessment form. The parent handbook or operational policies set forth your program's philosophy and values.

The enrollment interview is the time to obtain critical information about the child and provide information on your program's operational policies, such as health checks (if conducted), procedures for the release of children, and illness and exclusion criteria. It also provides parents an opportunity to assess your program and determine if it is best suited for their child's needs.

Child Assessment Form

Child Name (last, first, middle)	Social Security No.*	Enrollment Date	Date of Birth
Street Address (if rural, attach directions)	City	County	Zip
Mailing Address (if different) -- Street or P.O. Box	City	County	Zip
Telephone No. (include A/C)			

* If applicable.

1. Health

Does your child have any allergies?	<input type="checkbox"/> Yes	<input type="checkbox"/> No
If so, what allergies does your child have?		
How should we respond if he/she has an allergic reaction?		
Does your child have an existing illness?	<input type="checkbox"/> Yes	<input type="checkbox"/> No
Has your child had a previous serious illness or injury, or hospitalization during the past 12 months?	<input type="checkbox"/> Yes	<input type="checkbox"/> No
Is your child taking any medication?	<input type="checkbox"/> Yes	<input type="checkbox"/> No
If so, how is the medication administered, and will it need to be administered while he/she is in care?		
Is the medication prescribed for continuous use?	<input type="checkbox"/> Yes	<input type="checkbox"/> No
Are there any side effects we should be alerted to?	<input type="checkbox"/> Yes	<input type="checkbox"/> No

2. Toileting:

Does your child need assistance with toileting?	<input type="checkbox"/> Yes	<input type="checkbox"/> No
How can we best help?		
What are your ideas about toilet training?		
How can we best help?		

3. Behavior:

Does your child have any special fears?	<input type="checkbox"/> Yes	<input type="checkbox"/> No
How does your child communicate his/her needs?	<input type="checkbox"/> Yes	<input type="checkbox"/> No
Are there any special words that your child uses that might not be readily recognized?		
How do you tell your child to stop a behavior that you don't approve of or that might be dangerous?		
When your child gets upset, what helps him/her calm down?		
What is a good way to distract your child when he/she is having a temper tantrum?		
Are there any particular routines that are particularly helpful at naptime?		

Child Assessment Form

What position is most comfortable for your child when he/she is napping?	
--	--

4. Eating Preferences:

What are your child's favorite foods?	
Does your child use utensils, eat with fingers, feed self?	
Does your child choke easily while eating?	<input type="checkbox"/> Yes <input type="checkbox"/> No

5. Activities:

What activities do you like to do with your child?	
What activities does your child like to do when playing with other children?	
What does your child like to do when he is playing alone?	

6. Family History:

Tell me about your family (i.e. child's parents, siblings, grandparents, and other extended family)	
---	--

I verify that the above assessment was discussed with the parent(s) of _____

Signature of Director

Date Signed

I verify that the director appropriately relayed the information concerning my child's assessment.

Signature of Parent

Date Signed

Additional Comments:

--



OPERATIONAL DISCIPLINE AND GUIDANCE POLICY

Purpose: This form provides the required information per minimum standards §744.501(7), §746.501(a)(7), and §747.501(5).

Directions: Parents will review this policy upon enrolling their child. Employees, household members, and volunteers will review this policy at orientation. A copy of the policy is provided in the operational policies.

DISCIPLINE AND GUIDANCE POLICY

Discipline must be:

- 1) Individualized and consistent for each child;
- 2) Appropriate to the child's level of understanding; and
- 3) Directed toward teaching the child acceptable behavior and self-control.

A caregiver may only use positive methods of discipline and guidance that encourage self-esteem, self-control, and self-direction, which include at least the following:

- 1) Using praise and encouragement of good behavior instead of focusing only upon unacceptable behavior;
- 2) Reminding a child of behavior expectations daily by using clear, positive statements;
- 3) Redirecting behavior using positive statements; and
- 4) Using brief supervised separation or time out from the group, when appropriate for the child's age and development, which is limited to no more than one minute per year of the child's age.

There must be no harsh, cruel, or unusual treatment of any child. The following types of discipline and guidance are prohibited:

- 1) Corporal punishment or threats of corporal punishment;
- 2) Punishment associated with food, naps, or toilet training;
- 3) Pinching, shaking, or biting a child;
- 4) Hitting a child with a hand or instrument;
- 5) Putting anything in or on a child's mouth;
- 6) Humiliating, ridiculing, rejecting, or yelling at a child;
- 7) Subjecting a child to harsh, abusive, or profane language;
- 8) Placing a child in a locked or dark room, bathroom, or closet with the door closed or open; and
- 9) Requiring a child to remain silent or inactive for inappropriately long periods of time for the child's age.

ADDITIONAL DISCIPLINE AND GUIDANCE MEASURES (ONLY APPLIES TO BAP/SAP PROGRAMS THAT OPERATE UNDER CHAPTER 744)

A program must take the following steps if it uses disciplinary measures for teaching a skill, talent, ability, expertise, or proficiency:

- Ensure that the measures are considered commonly accepted teaching or training techniques;
- Describe the training and disciplinary measures in writing to parents and employees and include the following information:
 - (A) The disciplinary measures that may be used, such as physical exercise or sparring used in martial arts programs;
 - (B) What behaviors would warrant the use of these measures; and
 - (C) The maximum amount of time the measures would be imposed;
- Inform parents that they have the right to ask for additional information; and
- Ensure that the disciplinary measures used are not considered abuse, neglect, or exploitation as specified in Texas Family Code §261.001 and Chapter 745, Subchapter K, Division 5, of this title (relating to Abuse and Neglect).



SIGNATURE

This policy is effective on the following date:

Signed by:

X

Role:

- Parent Caregiver/Employee
 Household Member (Ch. 747 only)

MINIMUM STANDARDS RELATED TO DISCIPLINE

- Title 40, Chapter 746 Subchapter L:
[http://texreg.sos.state.tx.us/public/readtac\\$ext.ViewTAC?tac_view=5&ti=40&pt=19&ch=746&sch=L&rl=Y](http://texreg.sos.state.tx.us/public/readtac$ext.ViewTAC?tac_view=5&ti=40&pt=19&ch=746&sch=L&rl=Y)
- Title 40, Chapter 747 Subchapter L
[http://texreg.sos.state.tx.us/public/readtac\\$ext.ViewTAC?tac_view=5&ti=40&pt=19&ch=747&sch=L&rl=Y](http://texreg.sos.state.tx.us/public/readtac$ext.ViewTAC?tac_view=5&ti=40&pt=19&ch=747&sch=L&rl=Y)
- Title 40, Chapter 744 Subchapter G:
[http://texreg.sos.state.tx.us/public/readtac\\$ext.ViewTAC?tac_view=5&ti=40&pt=19&ch=744&sch=G&rl=Y](http://texreg.sos.state.tx.us/public/readtac$ext.ViewTAC?tac_view=5&ti=40&pt=19&ch=744&sch=G&rl=Y)